

Manual
Knife Mill Grindomix GM200



Translation

Retsch[®]

Copyright

© Copyright by
Retsch GmbH
Haan, Retsch-Allee 1-5
D-42781 Haan
Federal Republic of Germany

1	Notes on the Operating Manual	6
1.1	Explanations of the safety warnings	7
1.2	General safety instructions	8
1.3	Repairs	9
2	Confirmation	10
3	Transport, scope of delivery, installation	11
3.1	Packaging	11
3.2	Transport	11
3.3	Temperature fluctuations and condensed water	11
3.4	Conditions for the place of installation	11
3.5	Installation of the machine	11
3.6	Electrical connection	11
3.7	Type plate description	12
4	Technical data	13
4.1	Use of the machine for the intended purpose	13
4.2	Working instructions	13
4.3	Protective equipment	14
4.4	Drive output	14
4.5	Rated power	14
4.6	Motor rotation speed	14
4.7	Rated voltage	14
4.8	Emissions	14
4.8.1	Noise measurement Example 1:	15
4.8.2	Noise measurement Example 2:	15
4.9	Degree of protection	15
4.10	Dimensions and weight	15
4.11	Required floor space	15
5	Operating the machine	16
5.1	Views of the Instrument	16
5.2	Overview table of the parts of the device	18
5.3	Overview Table of the Operating Elements and the Display	19
5.4	Operating the Device	20
5.5	Switching On and Off	20
5.6	Opening and closing of the grinding chamber	21
5.7	Inserting the grinding jar	21
5.8	Use of grinding jugs depending on different materials	21
5.8.1	Grinding jar - plastic container (PP)	21
5.8.2	Grinding jar - glass container (Borosilicate glass 3.3)	22
5.8.3	Grinding jar - stainless steel container	22
5.8.4	Grinding jar - plastic container (PC)	22
5.9	Lid and jug combinations	22
5.9.1	Standard lid	23
5.9.2	Adapter lid	23
5.9.3	Gravitation lid	24
5.10	Filling the vessel	25
5.10.1	Filling – within the device	25

5.10.2	Filling – outside the device	26
5.11	Setting the grinding time	27
5.12	Setting the Speed	28
5.13	Switching on interval or continuous mode	28
5.14	Reverse grinding.....	29
5.15	Quick Start – button function	29
5.16	Store functions	30
5.16.1	Saving programs.....	30
5.16.2	Starting a saved program	30
5.17	Start – Pause – Stop.....	30
5.17.1	Pause function	30
5.17.2	Premature termination of grinding	30
5.18	Resetting the overload protection	30
6	Cleaning and service	31
6.1	Cleaning the Grinding Tools	31
6.2	Check the sealing lip.....	32
7	Fault messages.....	32
8	Disposal.....	34
9	Index	35
Appendix following page	

1 Notes on the Operating Manual

This operating manual is a technical guide on how to operate the device safely and it contains all the information required for the areas specified in the table of contents. This technical documentation is a reference and instruction manual. The individual chapters are complete in themselves.

Familiarity (of the respective target groups defined according to area) with the relevant chapters is a precondition for the safe and appropriate use of the device.

This operating manual does not contain any repair instructions. If faults arise or repairs are necessary, please contact your supplier or get in touch with Retsch GmbH directly.

Application technology information relating to samples to be processed is not included but can be read on the Internet on the respective device's page at www.retsch.com.

Changes

Subject to technical changes.

Copyright

Disclosure or reproduction of this documentation, use and disclosure of its contents are only permitted with the express permission of Retsch GmbH.

Infringements will result in damage compensation liability.

1.1 Explanations of the safety warnings

In this Operating Manual we give you the following safety warnings

Serious injury may result from failing to heed these safety warnings. We give you the following warnings and corresponding content.

 **WARNING**

Type of danger / personal injury

Source of danger

- Possible consequences if the dangers are not observed.
 - **Instructions on how the dangers are to be avoided.**
-

We also use the following signal word box in the text or in the instructions on action to be taken:

 **WARNING**

Moderate or mild injury may result from failing to heed these safety warnings. We give you the following warnings and corresponding content.

 **CAUTION**

Type of danger / personal injury

Source of danger

- Possible consequences if the dangers are not observed.
 - **Instructions on how the dangers are to be avoided.**
-

We also use the following signal word box in the text or in the instructions on action to be taken:

 **CAUTION**

In the event of possible **property damage** we inform you with the word “Instructions” and the corresponding content.

NOTICE

Nature of the property damage

Source of property damage

- Possible consequences if the instructions are not observed.
 - **Instructions on how the dangers are to be avoided.**
-

We also use the following signal word in the text or in the instructions on action to be taken:

NOTICE

1.2 General safety instructions

 **CAUTION**

Read the Operating Manual

Non-observance of these operating instructions

- The non-observance of these operating instructions can result in personal injuries.
- **Read the operating manual before using the device.**
- **We use the adjacent symbol to draw attention to the necessity of knowing the contents of this operating manual.**



Target group : All persons concerned with the machine in any form

This machine is a modern, high performance product from Retsch GmbH and complies with the state of the art. Operational safety is given if the machine is handled for the intended purpose and attention is given to this technical documentation.

You, as the owner/managing operator of the machine, must ensure that the people entrusted with working on the machine:

- have noted and understood all the regulations regarding safety,
- are familiar before starting work with all the operating instructions and specifications for the target group relevant for them,
- have easy access always to the technical documentation for this machine,
- and that new personnel before starting work on the machine are familiarised with the safe handling of the machine and its use for its intended purpose, either by verbal instructions from a competent person and/or by means of this technical documentation.

Improper operation can result in personal injuries and material damage. You are responsible for your own safety and that of your employees.

Make sure that no unauthorised person has access to the machine.

 **CAUTION**

Changes to the machine

- Changes to the machine may lead to personal injury.
- **Do not make any change to the machine and use spare parts and accessories that have been approved by Retsch exclusively.**

NOTICE

Changes to the machine

- The conformity declared by Retsch with the European Directives will lose its validity.
 - You lose all warranty claims.
 - **Do not make any change to the machine and use spare parts and accessories that have been approved by Retsch exclusively.**
-

2 Confirmation

This operating manual contains essential instructions for operating and maintaining the device which must be strictly observed. It is essential that they be read by the operator and by the qualified staff responsible for the device before the device is commissioned. This operating manual must be available and accessible at the place of use at all times.

The user of the device herewith confirms to the managing operator (owner) that (s)he has received sufficient instructions about the operation and maintenance of the system. The user has received the operating manual, has read and taken note of its contents and consequently has all the information required for safe operation and is sufficiently familiar with the device.

As the owner/managing operator you should for your own protection have your employees confirm that they have received the instructions about the operation of the machine.

I have read and taken note of the contents of all chapters in this operating manual as well as all safety instructions and warnings.

User

Surname, first name (block letters)

Position in the company

Signature

Service technician or operator

Surname, first name (block letters)

Position in the company

Place, date and signature

3 Transport, scope of delivery, installation

3.1 Packaging

The packaging has been adapted to the mode of transport. It complies with the generally applicable packaging guidelines.

3.2 Transport

NOTICE

Transport

- Mechanical or electronic components may be damaged.
 - **The machine may not be knocked, shaken or thrown during transport.**
-

3.3 Temperature fluctuations and condensed water

NOTICE

Temperature fluctuations

The machine may be subject to strong temperature fluctuations during transport (e.g. aircraft transport)

- The resultant condensed water may damage electronic components.
 - **Protect the machine from condensed water.**
-

3.4 Conditions for the place of installation

Ambient temperature: 5°C to 40°C

NOTICE

Ambient temperature

- Electronic and mechanical components may be damaged and the performance data alter to an unknown extent.
 - **Do not exceed or fall below the permitted temperature range of the machine (5°C to 40°C / ambient temperature).**
-

3.5 Installation of the machine

Installation height: maximum 2000 m above sea level

3.6 Electrical connection

WARNING

When connecting the power cable to the mains supply, use an external fuse that complies with the regulations applicable to the place of installation .

- Please check the type plate for details on the necessary voltage and frequency for the device.
- Make sure the levels agree with the existing mains power supply.

- Use the supplied connection cable to connect the device to the mains power supply.

3.7 Type plate description

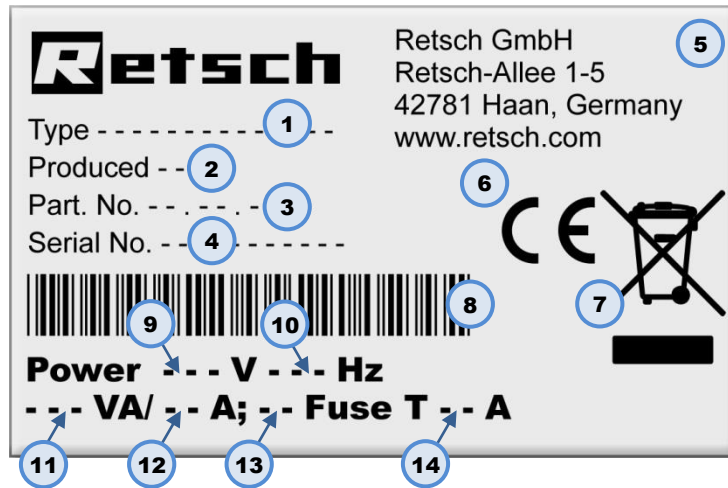

Fig. 1: Type plate lettering

- 1 Device designation
- 2 Year of production
- 3 Part number
- 4 Serial number
- 5 Manufacturer's address
- 6 CE marking
- 7 Disposal label
- 8 Bar code
- 9 Power version
- 10 Mains frequency
- 11 Capacity
- 12 Amperage
- 13 Number of fuses
- 14 Fuse type and fuse strength

In the case of questions please provide the device designation (1) or the part number (3) and the serial number (4) of the device.

4 Technical data

4.1 Use of the machine for the intended purpose

 **CAUTION**

Risk of explosion or fire

Changing sample characteristics

- Note that the characteristics and accordingly the danger presented by a sample can change during sieving.
- **Do not sieve any potentially explosive or combustible materials in this device.**

 **CAUTION**

Risk of explosion or fire

– On account of its design, the device is not suitable for use in hazardous (potentially explosive) atmospheres.

- **Do not operate the device in a hazardous atmosphere.**

 **CAUTION**

Danger of personal injury

Dangerous nature of the sample

- Depending on the dangerous nature of your sample, take the necessary measures to rule out any danger to persons.
- **Observe the safety guidelines and datasheets of your sample material.**



Target group: operators

Machine type designation: GM 200

This device is suitable for analytical grinding, homogenisation and mixing of soft to medium-hard, aqueous, fatty, fibrous and dry materials in seconds. This device is designed for quantities of approximately 700ml, large volume materials up to 1000ml.

The feed size is < 30 - 40 mm.

The device is specially designed for the grinding of the following materials :

Fish, meat, vegetables, cheese, preserves, seeds, bacon, sausage, dry baked goods and pastries, all aqueous, fatty and fibrous products and similar materials.

The device is designed as a laboratory device for 8-hour one-shift operation with a 30% ON duration.

It is not intended for use as production machine and not intended for the mixing and homogenisation of liquids with low viscosity (emulsions and suspensions) .

4.2 Working instructions

The grinding process in the device takes place by means of cutting and by means of impact effect during reverse operation.

The cutting blades are arranged so that they are straight and at right angles to the direction of rotation.

This cutting geometry enables the entire inert force resulting from the speed difference between sample material particles and cutting blade to be used as cutting force.

The speed is between 2000 - 10000min⁻¹, is altered in steps of 500min⁻¹ and is displayed digitally.

The preselected speed is kept constant during grinding by a speed controller. The preselected speed can nevertheless be reset during operation (exception: operation of the program)

Interval operation has proven to be advantageous in the pre-crushing and homogenisation of coarse, tough, fibrous and also very soft or visco-elastic products.

A grinding duration of up to 3 minutes can be set. The motor switches off automatically on expiry of the grinding duration, and the housing lid opens.

3 memories are available for saving and retrieving frequently used speed/time combinations at the press of a button.

4.3 Protective equipment

The grinding chamber of this device is interlocked by a resistant protective hood.

It is only possible to start the device when the protective hood is closed. The motor must have come to a standstill to open the device.

In the event of fault there is also an electric emergency brake which brings the cutters to a standstill in fractions of a second from the highest speed.

If the achievable current speed deviates from the setpoint speed by more than 5% due to an overload, this is shown by flashing displays.

4.4 Drive output

Universal electric motor

4.5 Rated power

Motor performance: approx. 1000 watts

4.6 Motor rotation speed

Speed: 2000 rpm⁻¹.... 10,000 rpm⁻¹ (can be altered in steps of 500 Umin⁻¹)

4.7 Rated voltage

Rated voltages:	230 V	50 Hz	(+/- 5%)
	100-120V	50/60 Hz	(+/- 5%)

4.8 Emissions



Possibility of acoustic signals not being heard

Loud grinding noises

- Acoustic alarms and voice communication might not be heard.

- **Consider the volume of the grinding noise in relation to other acoustic signals in the work environment. You may wish to use additional visual signals.**

Noise values: ~ 56 dB(A) (without sample material, beaker, cutters)

Noise measurement in accordance with DIN 45635-031-01-KL3

The noise values are also influenced by the properties of the sample medium.

4.8.1 Noise measurement Example 1:

Intensity of sound LWA

Workplace-related emission value LpAeq

Operating conditions:

Jug = glass jug with gravitation lid

Grind unit = cutter made of stainless steel

Feed material = tomatoes, quartered approx. 40 x 25mm

Feed quantity = 100g

4.8.2 Noise measurement Example 2:

Intensity of sound LWA

Workplace-related emission value LpAeq

Operating conditions:

jug = glass jug with gravitation lid

Grind unit = cutter made of stainless steel

Feed material = cheese approx. 20 x 20mm

Feed quantity = 100g

4.9 Degree of protection

- Grinding chamber and keypad - IP 42
- In the area of the ventilation slits - IP 20

4.10 Dimensions and weight

Closed:

Height: up to approx. 390mm

Width: 350mm

Depth : 250mm

with open hood:

Height: up to approx. 540mm

Width: 350mm

Depth : 410mm

Weight: approx. 10.1kg (without plastic container and cutter)

4.11 Required floor space

200 mm x 400 mm; no safety distances required.

5 Operating the machine

5.1 Views of the Instrument

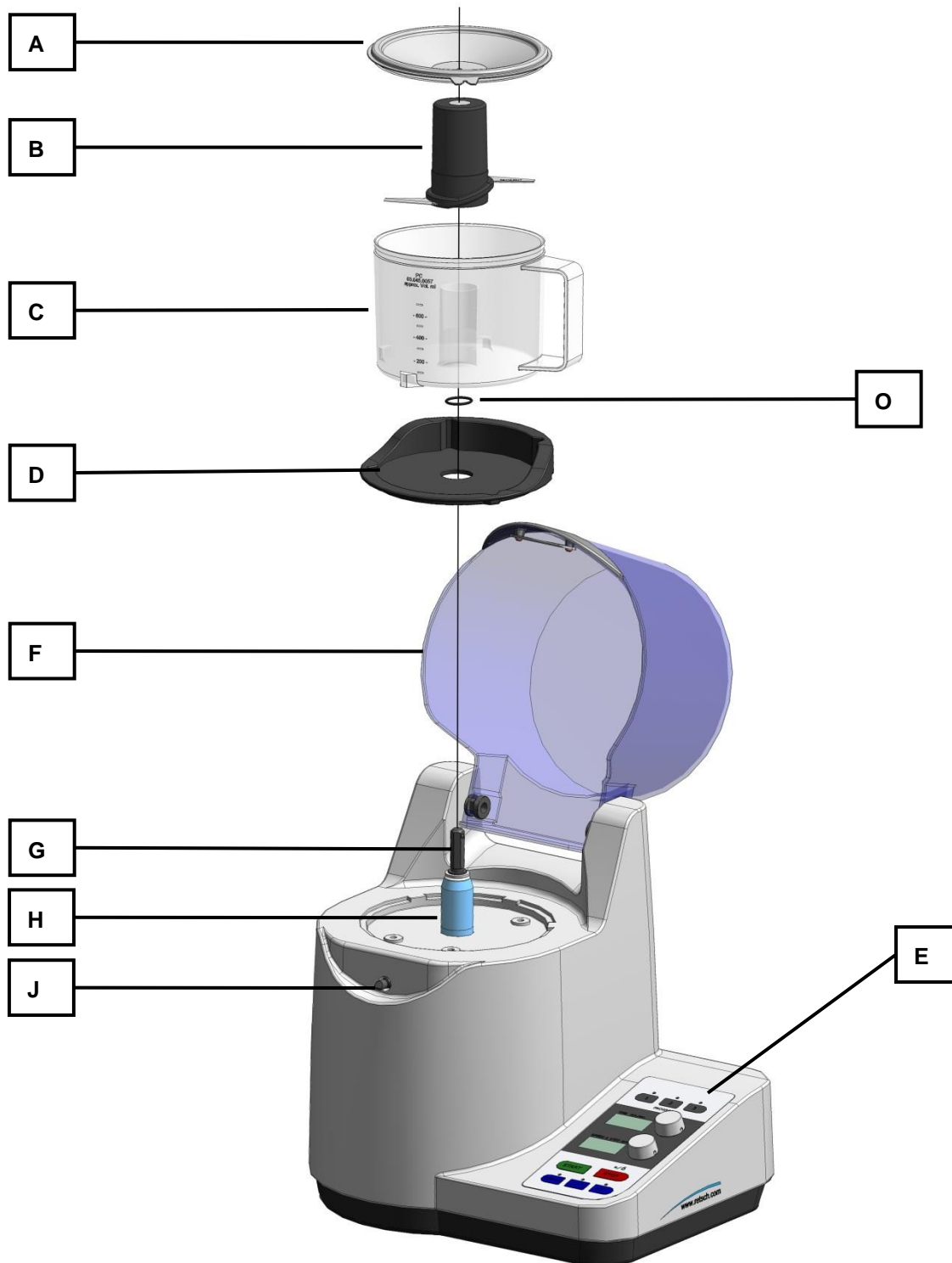

Fig. 2: Front view of the machine



Fig. 3: Rear view of the machine

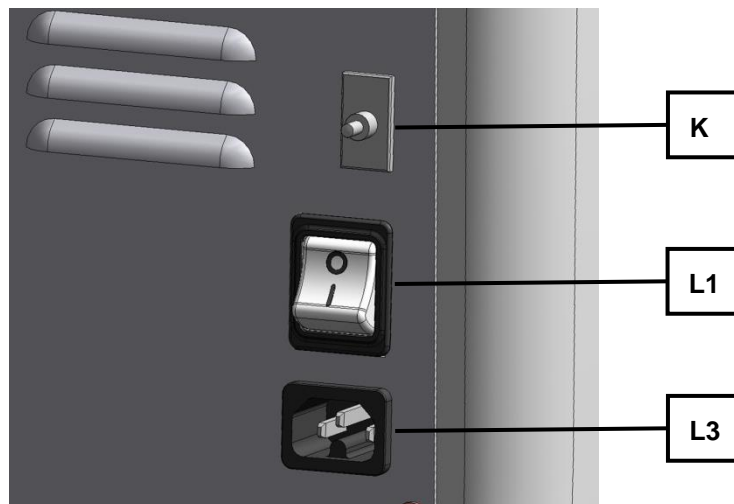

Fig. 4: Detail view of the socket for non-heating apparatus

5.2 Overview table of the parts of the device

Element	Description	Function
A	Jar lid	Seals the grinding jar
B	Knife cylinder	Cuts and grinds the sample material
C	Grinding jar	Holds the sample material
D	Jar holder	Holder for the grinding jar
E	Operating panel with displays	Start / stop / program memory and displays
F	Grinding chamber hood	Protective hood for safe grinding operations
G	Pin for knife cylinder	Drive shaft for knife cylinder
H	Support for grinding jar	Centres the grinding jar and the jar holder
J	Grinding chamber hood interlock	Locks the grinding chamber hood into place
K	Thermal fuse	Protective switch against overheating
L1	On/off switch	Separates the machine completely from the mains
L3	Socket for non-heating apparatus	Connection for mains cable
M	Vent	Ventilation of motor and inside chamber
O	O ring	Fixes the grinding chamber holder

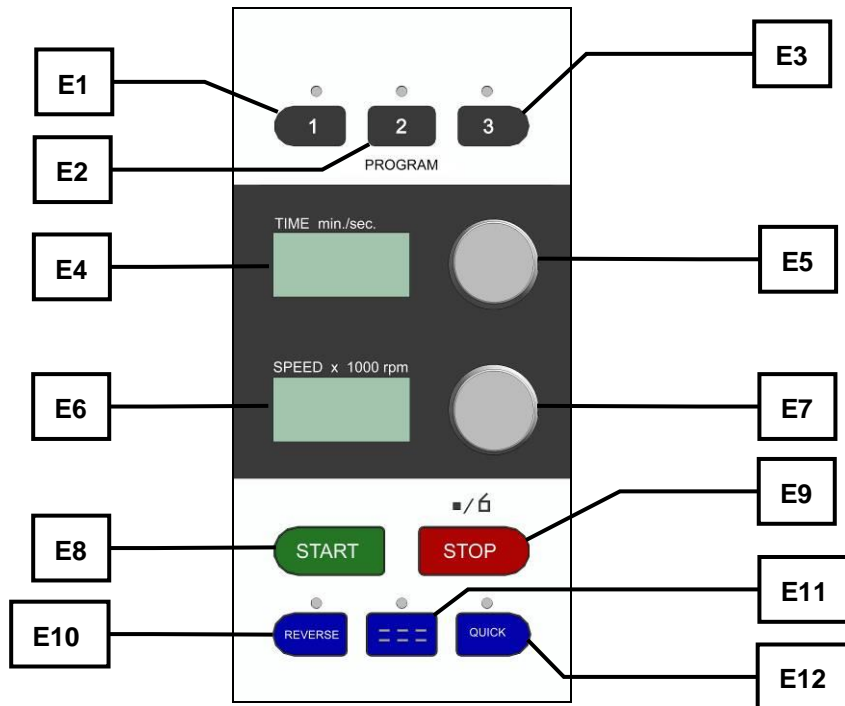

Fig. 5: Operating elements and displays

5.3 Overview Table of the Operating Elements and the Display

Element	Description	Function
E1	Program 1	Memory for program function
E2	Program 2	Memory for program function
E3	Program 3	Memory for program function
E4	Time display	Display of the remaining grinding time
E5	Time knob	Grinding time setting (1 second to 3 minutes)
E6	Speed display	Display of the set speed
E7	Speed knob	Speed setting
E8	START button	Start of grinding
E9	STOP / open button	End of grinding / opening of the protective hood
E10	REVERSE button	Direction reversal
E11	INTERVAL button	Grinding with short intervals
E12	QUICK button	Manually controlled grinding

5.4 Operating the Device

 **CAUTION**

Device falling down

Incorrect assembly or unsuitable workplace

- The appliance is very heavy and can therefore cause serious personal injuries if it falls down.

- **Operate the device only on a sufficiently large, firm, skid-resistant and steady workplace.**
- **Make sure that all equipment feet are steady.**

 **CAUTION**

Damage to hearing

The level of noise can be high depending on the type of material, the knife used, the speed set and the duration of the grinding process.

- Noise that is excessive in terms of level and duration can cause impaired or permanently damaged hearing.
- **Ensure suitable sound-proofing measures or wear hearing protection.**



5.5 Switching On and Off

The main switch is located on the reverse side of the device (L1).

- Switch the main switch on.

The grinding time last used appears in the TIME display.

The speed last used appears in the SPEED display.

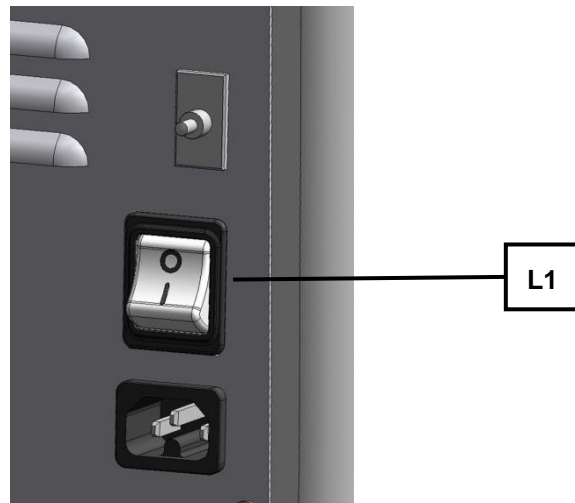

Fig. 6: Main switch

5.6 Opening and closing of the grinding chamber



CAUTION

Crushed or bruised fingers

Falling grinding chamber protective hood

- The protective hood of the grinding chamber can cause crushed or bruised fingers if it falls down.
- **Hold the flap tight when closing.**

- Briefly press the STOP button (E9).
The hood is unlocked and opens.

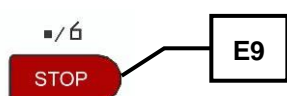

Fig. 7: Opening hood

5.7 Inserting the grinding jar

- Open the hood.
 - Insert the jug.
- Pay attention to the position of the jug when it is inserted.
N.B.
Ensure the correct position of the O ring (O).

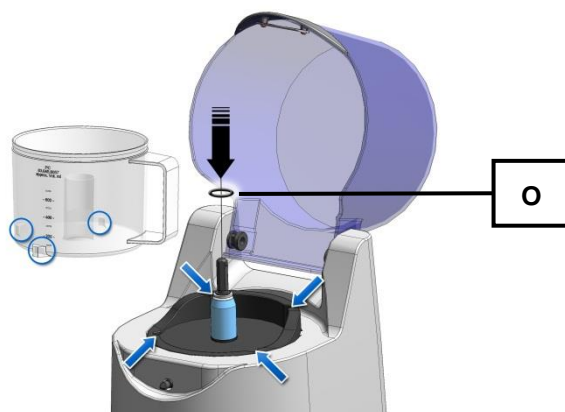

Fig. 8: Inserting jug

5.8 Use of grinding jugs depending on different materials

NOTICE

Grinding with liquid nitrogen (LN₂) or dry ice (CO₂) is not permitted in any variation of the GM.

Danger from brittleness and breakage of grinding tools or the glass and plastic containers.

1.H0053

5.8.1 Grinding jar - plastic container (PP)

Suitable for the following sample materials:

Soft, medium hard, elastic, aqueous, greasy and oily.

Unsuitable for the following sample materials:

Hard, hard and brittle,

e.g. cereals, briquettes and pellets, gelatine sweets.

(Increased abrasion in the plastic container)

5.8.2 Grinding jar - glass container (Borosilicate glass 3.3)

Suitable for the following sample materials:

Soft, medium hard, elastic, aqueous, greasy and oily.

Unsuitable for the following sample materials:

Hard, hard and brittle,

e.g. cereals, briquettes and pellets, gelatine sweets.

(Glass container may break)

5.8.3 Grinding jar - stainless steel container

Suitable for the following sample materials:

Soft, medium hard, elastic, aqueous, greasy and oily, hard to medium hard

e.g. cereals, frozen food, hard cheese and sausage products

5.8.4 Grinding jar - plastic container (PC)

Suitable for the following sample materials:

Soft, medium hard, elastic, aqueous, greasy and oily.

Unsuitable for the following sample materials:

Hard, hard and brittle,

e.g. cereals, briquettes and pellets, gelatine sweets.

(Increased abrasion in the plastic container)

5.9 Lid and jug combinations



1.V0028

Danger of injuries caused by cuts

Moving parts – jug, rotor and grinding jar lid

- The jug and the rotor may fall down after removal and cause injury.
- **Be aware and put down the components safely.**
- **Do not place any objects on the device.**

The various lid / container combinations make it possible to adjust to suit the requirements of different tasks.

NOTICE:

The feed quantity depends on the property of the sample material and of the type of lid.

Otherwise the container may overflow when grinding aqueous materials.

Do not exceed the recommended feed quantities.

5.9.1 Standard lid

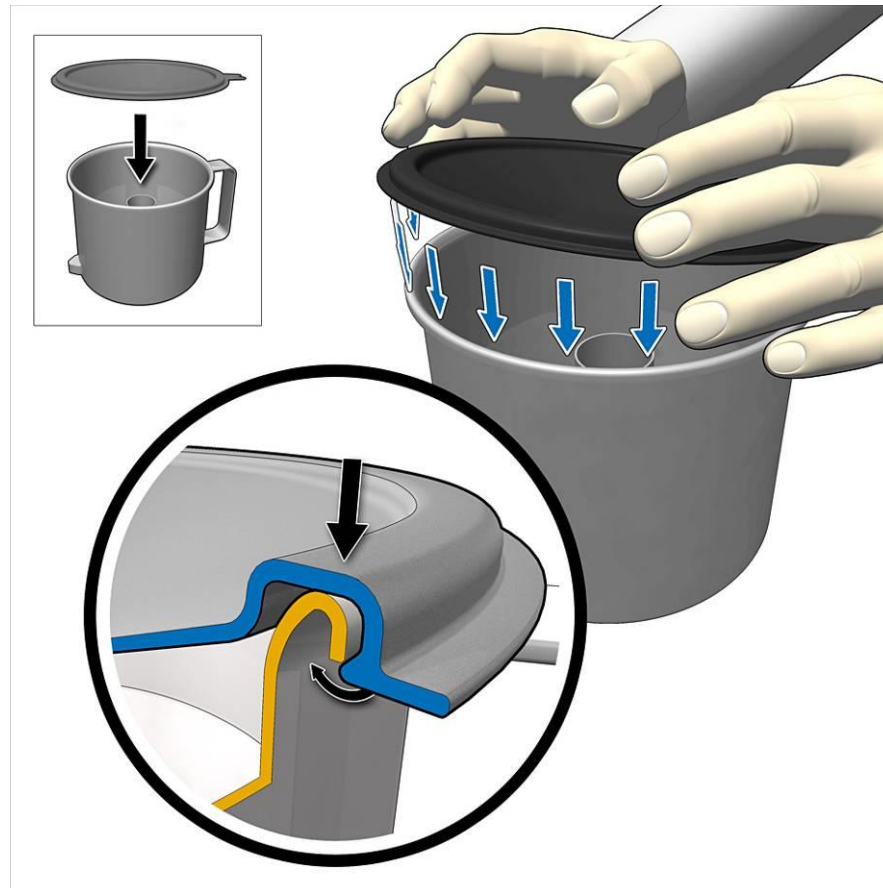

The standard lid is used for larger volumes of small pieces of material. The typical feed quantity is between 300 and a maximum 700ml.

The lid is clamped on the edge of the container and can be released again on the bracket.

NOTICE

The standard lid can be used both with the plastic/steel and the glass container..

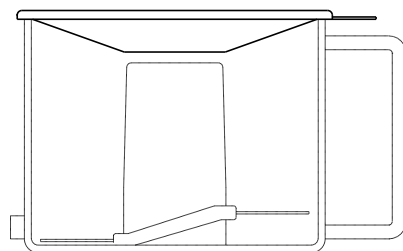

Fig. 9: Standard lid

5.9.2 Adapter lid

The adapter lid is used for smaller volumes of small pieces of material. The maximum feed quantity is 300ml, depending on the sample material.

- Position the adapter lid so that the edge rests on the top edge of the container.

During grinding, the adapter lid is held down by the hood.

NOTICE

The adapter lid may only be used with the plastic container.

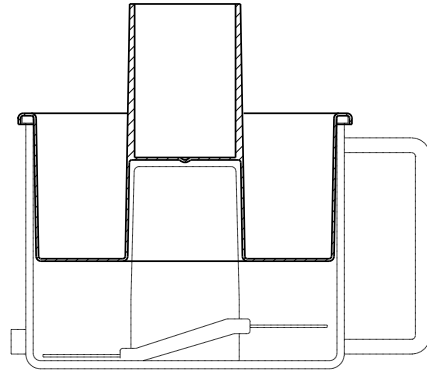

Fig. 10: Adapter lid

5.9.3 Gravitation lid

The gravitation lids permit an exact adjustment of the useful volume to the respective feed quantity. They move downwards during grinding, thereby optimising the grinding chamber volume. The feed quantity is a maximum of 300ml. The gravitation lid with overcurrent channels (⇒ is used for aqueous materials.

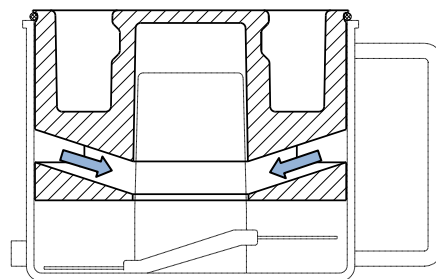

Fig. 4: Gravitation lid with overcurrent channels

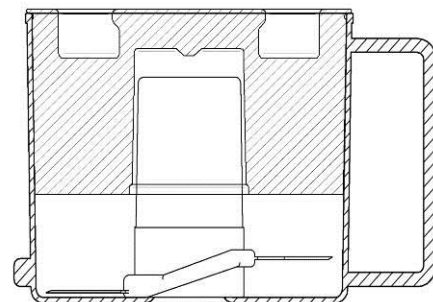

Fig. 5: Gravitation lid

NOTE

The gravitation lids for the plastic jug differ from the gravitation lids for the glass and steel grinding jugs.

5.10 Filling the vessel



1.V0039

Danger of injuries caused by cuts

Sharp cutters

- The cutters are very sharp and may lead to injuries caused by cuts if handled incorrectly.
- **Do not directly take hold of the cutters.**
- **Only reach into the grinding jar if it is outside the device.**
- **Do not reach into the grinding jar if the sample material still covers the cutter.**
- **Before taking out the cutter remove as much sample material to safely grip the cutter.**

NOTE

H0054

The hood must safely latch into the interlock pin so that the motor can start or so that no emergency brake is triggered during grinding.

Insert the cutter cylinder before adding the sample material because otherwise it may fall between cutter cylinder and jug.

5.10.1 Filling – within the device

- Insert the jug.
- Position the cutter cylinder and push it down as far as it will go.
- Add the sample material.
- Put on the lid.
- Close the hood until it latches into the interlock pin (**J**).

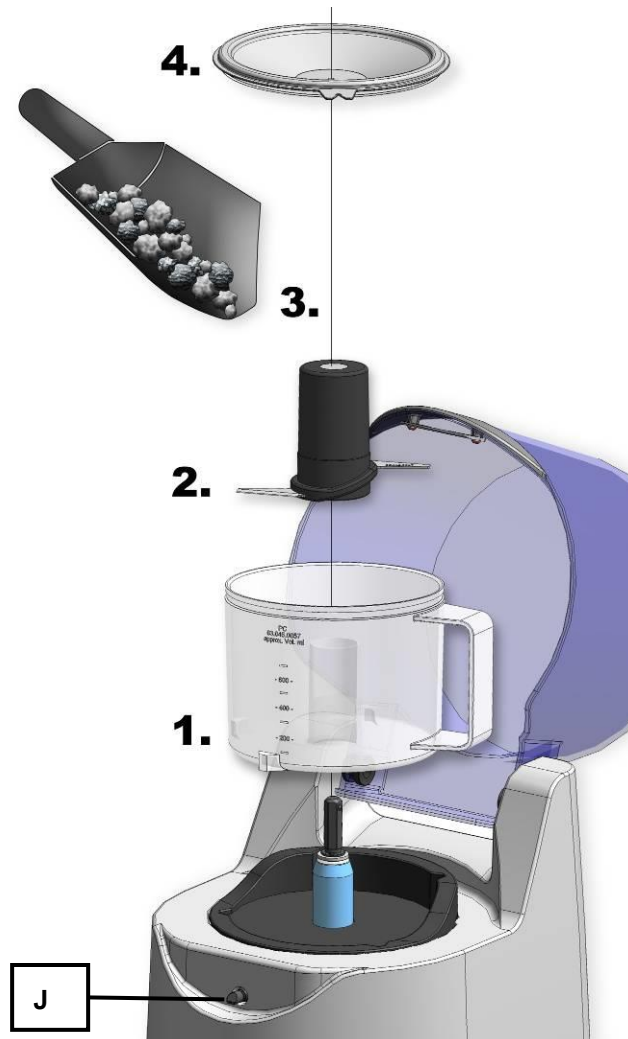

Fig. 6: Filling inside the device

5.10.2 Filling – outside the device

The container can also be filled before it is inserted into the device. This makes it possible to work simply with more than one container without intermediate cleaning.

Loading the containers outside the machine is only possible with the adapter lid and standard lid. The gravity lid is not suitable for this.

- Place the knife cylinder in the container.
- Add the sample material.
- Put the lid on.
- Press the lid downwards in the centre and insert the container in the device.

In the case of the adapter lid, pressing the lid down is absolutely essential to move the knife cylinder into its final position.

Do not use the gravity lid when loading the container outside the machine. If you do so, the knife will not engage.

- Close the hood until it engages in the locking bolts.

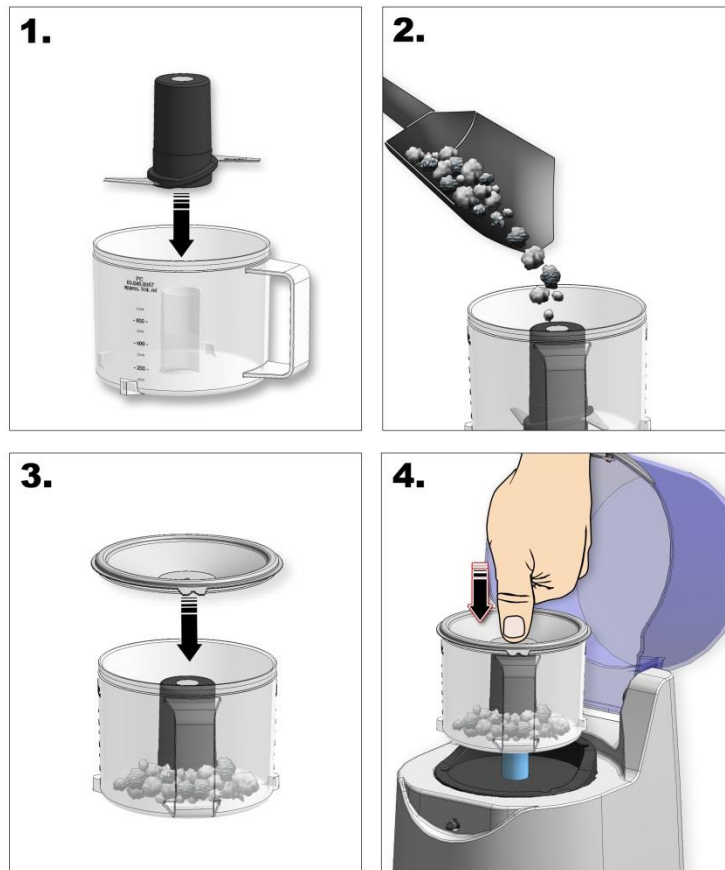
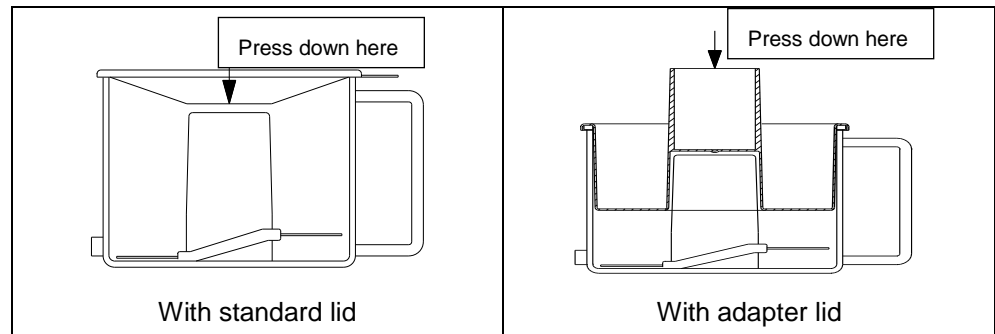

Fig. 11: Filling outside the device

5.11 Setting the grinding time

The grinding duration can be set from 1 second to 3 minutes in steps of 1 second.

- Turn the knob (E5) to the left to reduce the grinding duration.
- Turn the knob (E5) to the right to increase the grinding duration.

Turning slowly increases the time in steps of 1 second.

Turning quickly increases the grinding duration in steps of 1 minute.

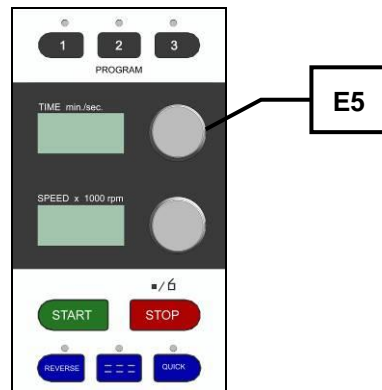

Fig. 8: Setting grinding duration

5.12 Setting the Speed

The speed can be set from 2000 min⁻¹ to 10.000 min⁻¹ in steps of 500 min⁻¹.

- Turn the knob (E7) to the left to reduce the speed.
- Turn the knob (E7) to the right to increase the speed.

Slow turning alters the speed in steps of 500 min⁻¹.
Fast turning alters the speed in steps of 3000 min⁻¹.

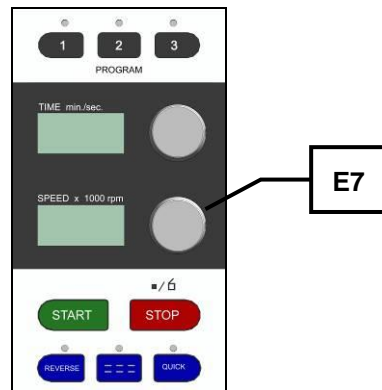

Fig. 12: Setting the speed

5.13 Switching on interval or continuous mode

- Press the interval button (E11).

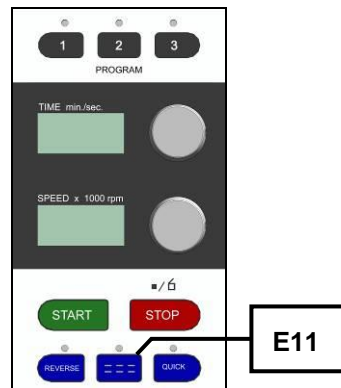

Fig. 13: Switching on interval operation

The LED over the button lights up. The set speed is shown in the display if it is not larger than 4000 rpm.

- Press the START button.
Grinding now takes place in the interval mode.
- To end interval grinding press the interval button (E11) once again.
The LED above the interval button goes out and the speed maintains the value of 4000 rpm. The device is in continuous mode again .

5.14 Reverse grinding

- Press the REVERSE button (E10).

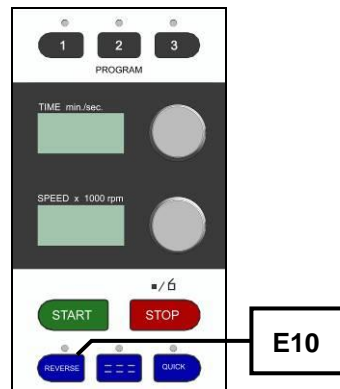

Fig. 14: Switching on interval operation
The LED above the REVERSE button lights up.

- Press the START button.
Grinding takes place in reverse mode and the motor runs against the cutting direction. Grinding takes place by impact unlike normal mode (cutting).
- Press the REVERSE button (E11) to leave the reverse mode again.
The LED above the REVERSE button lights up. The device is in normal mode once again – grinding by cutting .

5.15 Quick Start – button function

- Press the QUICK button (E12).

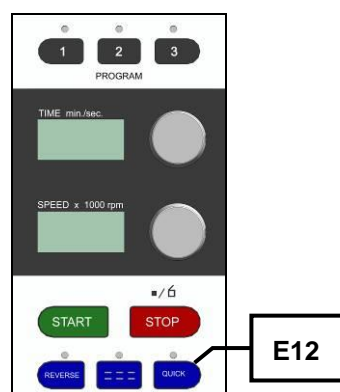

Fig. 15: QUICK grinding
The LED above the button lights up and grinding starts immediately.
• Release the QUICK button, grinding is ended immediately and the LED above the button goes out.

5.16 Store functions

5.16.1 Saving programs

- Keep the button **E1**, **E2** or **E3** pressed until the segment displays no longer flash.

The values for time and speed as well as the setting for REVERSE and INTERVAL operation are stored in the memory of the corresponding button.

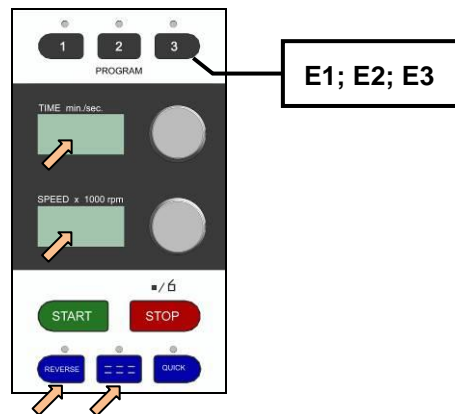

Fig. 16: Memory buttons

5.16.2 Starting a saved program

- Press the **E1**, **E2** or **E3** button.

The last saved values appear on the “TIME“ and “SPEED“ segment displays. The LEDs above the REVERSE and INTERVAL buttons light up depending on default. Press the START button to start grinding with the default parameters.

5.17 Start – Pause – Stop

5.17.1 Pause function

- Press the STOP button during grinding. Grinding is interrupted and the hood remains closed. It is not possible to move the set parameters (speed, time, interval, reverse). The current time display is suspended.
- Press the START button to continue grinding. Grinding is restarted and the time display runs again.

5.17.2 Premature termination of grinding

- Press the STOP button during grinding. Grinding is interrupted and the hood remains closed.
- Press the STOP button again. The device is switched off and the hood opens automatically. The parameters chosen for grinding (speed, time, interval, reverse) are displayed.

5.18 Resetting the overload protection

The overload protection switch (**K**) is situated on the rear panel.

This overload protection switch disconnects the device from the power supply if the machine is overloaded.

- After allowing the device to cool down it can be used with the power supply again by pressing the overload protection switch (**K**).

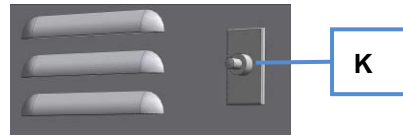

Fig. 17: Overload protection switch

6 Cleaning and service

⚠ WARNING

Risk of a fatal electric shock

- An electric shock can cause injuries in the form of burns and cardiac arrhythmia, respiratory arrest or cardiac arrest.
- **Do not clean the blender under running water. Use only a cloth dampened with water.**
- **Disconnect the power supply plug before cleaning the blender.**

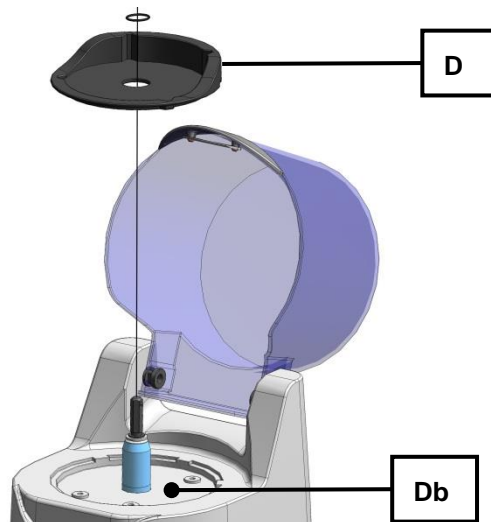

Fig. 18: Cleaning the jar support

NOTE

Sample material may get underneath the jar support (**Db**) where the jar support (**D**) frequently gets very dirty as a result of liquid or greasy samples.

- Where necessary also clean the area underneath the jar support (**Db**).
Material may otherwise, under unfavourable circumstances, get inside the device.

6.1 Cleaning the Grinding Tools

Material/device part	Dishwasher-proof	Autoclavable
Knife (stainless steel)	yes	yes
Knife (pure titanium)	yes	yes
Standard lid	yes	yes

Gravitation lid	yes	yes
Gravitation lid with overcurrent channels	yes	yes
Reduction lid	yes	yes
Plastic container (PP)	yes	no
Plastic container (PC)	yes	yes
Glass container	yes	yes
Stainless steel container	yes	yes

NOTICE

H0052

- Pay attention to the position of parts in the dishwasher.
- Do not place the plastic container, plastic lid or the knife near the heating element. Deformation can otherwise not be ruled out and further use of the parts will no longer be possible.

6.2 Check the sealing lip

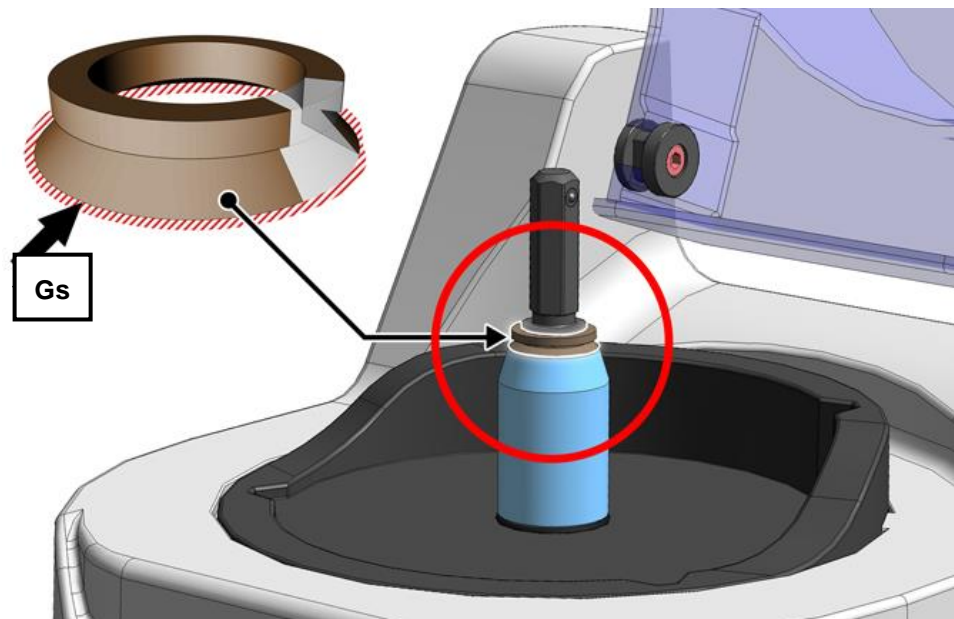

Fig. 19: Sealing lip (Gs)

Check the sealing lip (Gs) for damage at regular intervals.

- Replace the sealing lip (Gs) if damaged. [No. 05.111.0239]

Notice

Moisture can penetrate the inside of the housing if the sealing lip (Gs) is damaged.

7 Fault messages

F01	Motor is not running	
F02	Motor is switched off due to overload	Restart grinding process with small feed quantity.
F03	Motor speed too low / high	
F04	Hood open	
F05	Braking time too high	

F06	Motor overheated	Allow motor to cool and restart.
F07	Hood monitoring defective	Check the fault message: Press the START button when the hood is open. The "time" and "speed" segment displays flash evenly. Close the hood to rectify fault.
F08	Overspeed through hardware	

8 Disposal

Please observe the respective statutory requirements with respect to disposal. Information on disposal of electrical and electronic machines in the European Community.

Within the European Community the disposal of electrically operated devices is regulated by national provisions that are based on the EU Directive 2002/96/EC on Waste Electrical and Electronic Equipment (WEEE).

Accordingly, all machines supplied after 13.08.2005 in the business-to-business area to which this product is classified, may no longer be disposed of with municipal or household waste. To document this they have the following label:

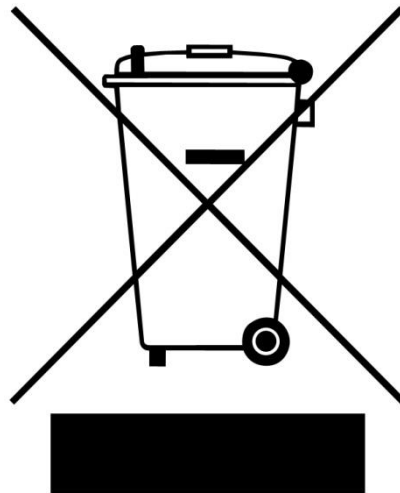

Fig. 20: Disposal label

Since the disposal regulations within the EU may differ from country to country we would request you to consult your supplier.

9 Index

A

Adapter lid 23, 24
Ambient temperature 11
Amperage 12
aqueous 22

B

Bar code 12
Borosilicate glass 22

C

Capacity 12
CE marking 12
Changes 6
Cleaning and service 31
Cleaning the Grinding Tools 31
Conditions for the place of installation 11
Confirmation 10
Connection cable 12
Continuous grinding 29
Continuous mode 29
Copyright 6

D

dB(A) 15
Degree of protection 15
Detail view of the socket for non-heating apparatus 17
Device designation 12
Dimensions and weight 15
DIN 45635-031-01-KL3 15
Disposal 34
Disposal label 12
Disposal label 34
Drive output 14

E

elastic 22
Electrical connection 11
Emissions 14
Emulsions 13
Explanations of the safety warnings 7
External fuse 11

F

F01 32
F02 32
F03 32
F04 32
F05 32
F06 33
F07 33
F08 33
Fault messages 32
Feed size 13

Filling – outside the device 26
Filling – within the device 25
Filling inside the device 26
Filling outside the device 27
Filling the vessel 25
Front view of the machine 16
Fuse strength 12
Fuse type 12

G

General safety instructions 8
Glass container 22
Gravitation lid 24
greasy 22

H

hard 22
hard and brittle 22

I

Inserting jug 21
Inserting the grinding jar 21
Installation height 11
Installation of the machine 11
Interval grinding 29

L

Lid and jug combinations 22
LWA 15

M

Main switch 20
Mains frequency 12
Manufacturer's address 12
Materials 13
medium hard 22
Memory buttons 30
Moderate or mild injury 7
Motor rotation speed 14

N

Noise measurement 15
noise values 15
Notes on the Operating Manual 6
Number of fuses 12

O

oily 22
Opening and closing of the grinding chamber 21
Opening hood 21
Operating elements and displays 19
Operating the Device 20
Operating the machine 16
Overcurrent channels 24
Overload protection switch 31

Overview Table of the Operating Elements and the Display 19
Overview table of the parts of the device 18

P

Packaging 11
Part number 12
Pausen function 30
PC 22
Plastic container 21, 22
Power version 12
Premature termination of grinding 30
property damage 7
Protective equipment 14

Q

QUICK grinding 29
Quick Start – button function 29

R

Rated power 14
Rated voltage 14
Rear view of the machine 17
Regulations for the place of installation 11
Repairs 9
Required floor space 15
Resetting the overload protection 30
Reverse grinding 29

S

Safety warnings 7
Sample materials 21, 22
Saving programs 30
Sealing lip 32
Serial number 12
serious injury 7
Service Address 9
Setting grinding duration 28
Setting the grinding time 27
Setting the speed 28

Setting the Speed 28
soft 22
Sound level 15
Stainless steel container 22
Standard lid 23
Standard lid 23
Start – Pause – Stop 30
Starting a saved program 30
Store functions 30
Suspensions 13
Switching On and Off 20
Switching on interval operation 28, 29
Switching on interval or continuous mode 28

T

Target group 8
Technical data 13
Temperature fluctuation and condensed water 11
Transport 11
Transport, scope of delivery, installation 11
Type plate 11
type plate description 12
Type plate lettering 12

U

Use of grind jugs depending on different materials 21
Use of the machine for the intended purpose 13

V

Views of the Instrument 16
Viscosity 13

W

Working instructions 13
Workplace-related emission value 15

Y

Year of production 12

LABORATORY KNIFE MILL

GM 200 - GRINDOMIX

Certificate of CE-Conformity according to:

EC Mechanical Engineering Directive 2006/42/EC

Applied harmonized standards, in particular:

DIN EN ISO 12100	Security of machines
DIN EN ISO 12852-5.1.1	Food processors and blenders
DIN EN ISO 13849-1	Safety related parts of control systems

EC Directive Electromagnetic Compatibility 2004/108/EC

Applied standards, in particular:

DIN EN 55011	Emission
DIN EN 61000-3-2 DIN EN 61000-3-3	Emission
DIN EN 61326-1	Immunity

Additional applied standards, in particular

DIN EN 61010-1	Safety prescriptions concerning measuring-, operating-, controlling- and laboratory equipment
----------------	---

Authorized person for the compilation of technical documents:

J. Bunke (technical documentation)

The following records are held by Retsch GmbH in the form of Technical Documentation:

Detailed records of engineering development, construction plans, study (analysis) of the measures required for conformity assurance, analysis of the residual risks involved and operating instructions in due form according to the approved regulations for preparation of user information data.

The CE-conformity of the Retsch Laboratory Knife Mill GM 200 is assured herewith.

In case of a modification to the machine not previously agreed with us as well as the use of not licensed spare parts and accessories this certificate will lose its validity.

Retsch GmbH

Haan, March 2011

Ralf Eisenbach Dipl.-Ing.





Copyright

® Copyright by
Retsch GmbH
Haan, Retsch-Allee 1-5
D-42781 Haan
Federal Republic of Germany